

SET MOLE STANDARD PER SAGOME "PE"

STANDARD SET WHEELS FOR "PE" SHAPE

Ø 100 Foro 22 / Hole 22 (mm)

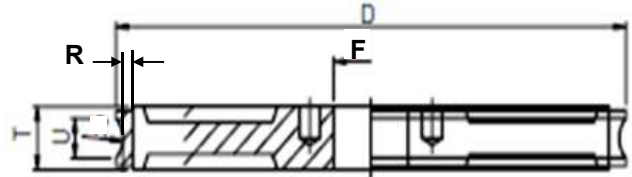

Pos	Vetro Glass	Duezeta Code	Descrizione / Description	Specif. 2Z	Note
U*	3	140017000551	1FF6Y F.22 Ø100 G.04 R.3 GR.MEDIA-K C.ST LEG.SLV1	230 SLV1	Unica standard
U*	3	140017000552	1FF6Y F.22 Ø100 G.04 R.3 GR.MEDIA-J C.ST LEG.SLV1	270 SLV1	Unica standard
2	3	140017000553	1FF6Y F.22 Ø100 G.04 R.3 GR.FINE-I C.ST LEG.SLV1	325 SLV1	
1	4	140017000554	1FF6Y F.22 Ø100 G.05 R.3 GR.GROSSA- P C.ST LEG.SLV1	100 SLV1	
2Alt	4	140017000555	1FF6Y F.22 Ø100 G.05 R.3 GR.FINE-K C.ST LEG.SLV1	230 SLV1	Opt. Pos.2
2	4	140017000556	1FF6Y F.22 Ø100 G.05 R.3 GR.FINE-J C.ST LEG.SLV1	270 SLV1	
1	5	140017000557	1FF6Y F.22 Ø100 G.06 R.3 GR.GROSSA- P C.ST LEG.SLV1	100 SLV1	
2Alt	5	140017000558	1FF6Y F.22 Ø100 G.06 R.3 GR.FINE-L C.ST LEG.SLV1	200 SLV1	Opt. Pos.2
2	5	140017000559	1FF6Y F.22 Ø100 G.06 R.3 GR.FINE-J C.ST LEG.SLV1	270 SLV1	
1	6	140017000560	1FF6Y F.22 Ø100 G.07 R.3 GR.GROSSA- P C.ST LEG.SLV1	100 SLV1	
2Alt	6	140017000561	1FF6Y F.22 Ø100 G.07 R.3 GR.FINE-K C.ST LEG.SLV1	230 SLV1	Opt. Pos.2
2	6	140017000562	1FF6Y F.22 Ø100 G.07 R.3 GR.FINE-J C.ST LEG.SLV1	270 SLV1	
**	6	140017000563	1FF6Y F.22 Ø100 G.07 R.3 GR.MEDIA-M C.ST LEG.SLV1	170 SLV1	Unica senza lucidatura
**	6	140017000564	1FF6Y F.22 Ø100 G.07 R.3 GR.MEDIA-L C.ST LEG.SLV1	200 SLV1	Unica senza lucidatura
1	8	140017000565	1FF6Y F.22 Ø100 G.09 R.3 GR.GROSSA- P C.ST LEG.SLV1	100 SLV1	
2	8	140017000566	1FF6Y F.22 Ø100 G.09 R.3 GR.FINE-K C.ST LEG.SLV1	230 SLV1	
1	10	140017000567	1FF6Y F.22 Ø100 G.11 R.3 GR.GROSSA- P C.ST LEG.SLV1	100 SLV1	
2	10	140017000568	1FF6Y F.22 Ø100 G.11 R.3 GR.FINE-K C.ST LEG.SLV1	230 SLV1	
1	12	140017000569	1FF6Y F.22 Ø100 G.13 R.3 GR.GROSSA- Q C.ST LEG.SLV1	80 SLV1	
2	12	140017000570	1FF6Y F.22 Ø100 G.13 R.3 GR.FINE-K C.ST LEG.SLV1	230 SLV1	
1	15	140017000571	1FF6Y F.22 Ø100 G.17 R.3 GR.GROSSA- R C.ST LEG.SLV1	70 SLV1	
2	15	140017000572	1FF6Y F.22 Ø100 G.17 R.3 GR.MEDIA-N C.ST LEG.SLV1	140 SLV1	
3	15	140017000573	1FF6Y F.22 Ø100 G.17 R.3 GR.FINE-K C.ST LEG.SLV1	230 SLV1	
1	19	140017000574	1FF6Y F.22 Ø100 G.21 R.3 GR.GROSSA- R C.ST LEG.SLV1	70 SLV1	
2	19	140017000575	1FF6Y F.22 Ø100 G.21 R.3 GR.MEDIA-N C.ST LEG.SLV1	140 SLV1	
3	19	140017000576	1FF6Y F.22 Ø100 G.21 R.3 GR.FINE-K C.ST LEG.SLV1	230 SLV1	

SET MOLE STANDARD PER SAGOME "PE"

STANDARD SET WHEELS FOR "PE" SHAPE

∅ 100 Foro 22 / Hole 22 (mm)

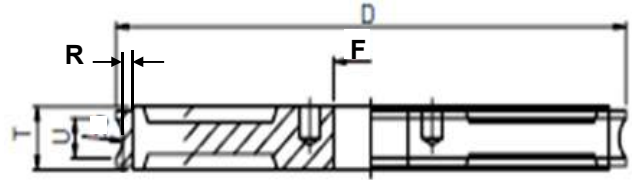

**Pos.1**  
(Met.bond)

**Pos.2**  
(Met.bond)

**Pos.3**  
(Met.bond)

Polishing

#### PARAMETRI DI LAVORO / WORKING PARAMETERS

Grana / Grit	RPM / (giri/')	Asportaz. / Removal	Avanzamento/Feed
70 to 120	7.500 ÷ 8.000	max. 2 mm	4 ÷ 8 m/min
140 to 230	7.500 ÷ 8.000	max. 0,6 mm	3 ÷ 12 m/min
270 to 325	7.500 ÷ 8.000	max. 0,35 mm	3 ÷ 12 m/min